

LEGEND

— Application Boundary

1 Site Plan Proposed
1:500

Site Plan Proposed

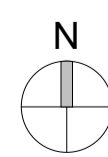
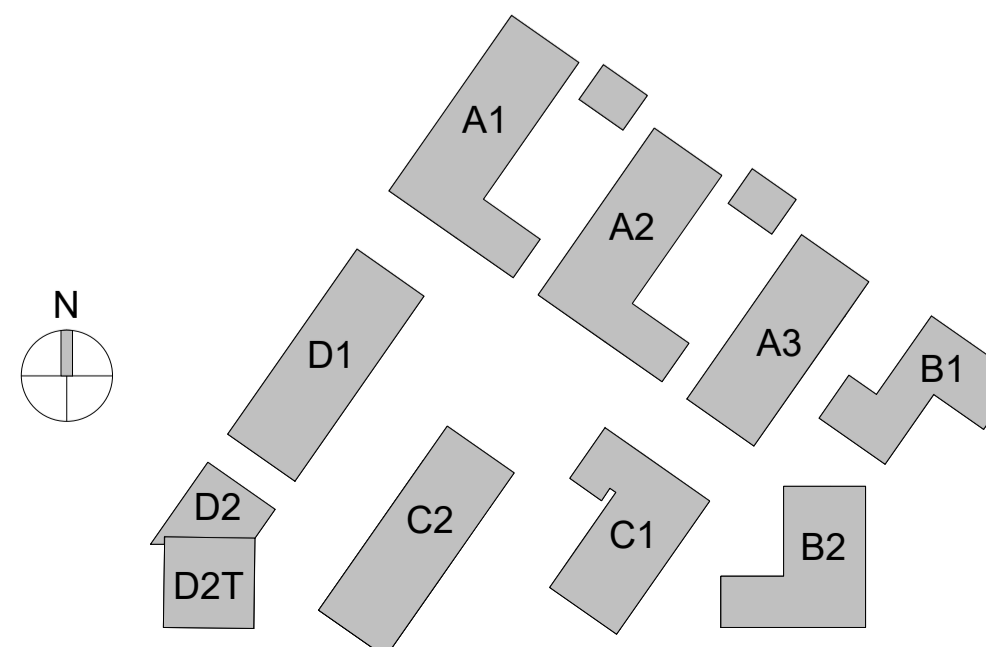

Revision Description	Date	Rev. No.	Issued by
SHD Lodgment to ABP	24-04-2019	1	JS/ES

Figured dimensions only to be used. This drawing is copyright of O'Mahony Pike Architects Ltd. All information is shared as per approved use in accordance with BS1192(2007) + A2(2016), Table 5; Standard Codes for Suitability of Models and Documents. If 'Information Approval Check' is empty, this information has been shared at 50 - WIP.

o'mahony pike

architecture | urban design | Dublin | Cork
 email: info@omahonypike.com | The Chapel | 26 South Mall
 tel: +353 1 202 7400 | Mount St. Anne's | Cork City
 fax: +353 1 283 0822 | Milltown, Dublin 6 | Co. Cork
 www.omahonypike.com | D06 XNS2 Ireland | T12 R2RV Ireland

Project No.: 1804 **Scale @ A1:** 1 : 500
Project Lead: DM **Date Printed:** 24-04-2019
Drawn By: JS/ES **Current Rev.:** 1
Model No.: 1804-OMP-ZZ-ZZ-M3-A-XX-00001
Purpose: Planning

Project: East Rd SHD
Location: East Wall, Dublin 3
Client: Glenveagh Living Ltd.

Drawing Title: Site Plan Proposed
Drawing No.: 1804-OMP-00-00-DR-A-XX-11003

Suitability Checked By: Date